

M204 Monkey Light®

Telepítési útmutató

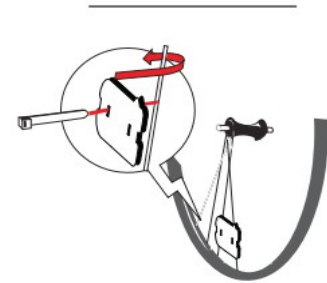
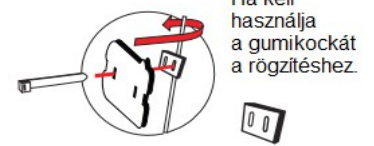
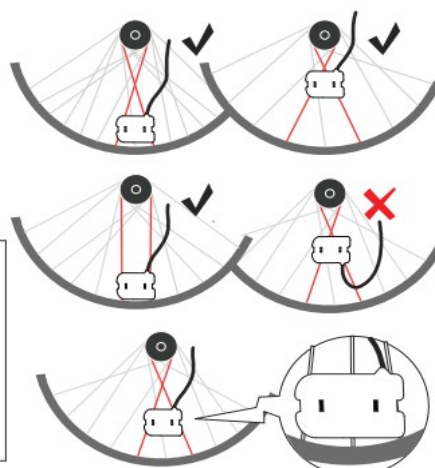
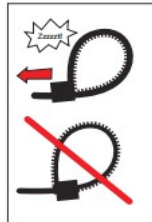
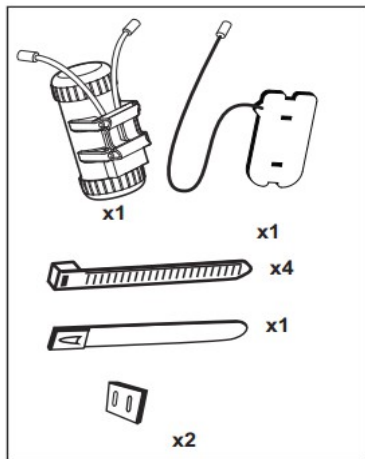

1. Igazítsa a küllőkhöz.

2. Rögzítse a 1. ponton a küllőhöz.

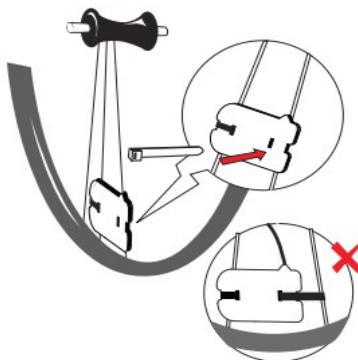

3. Rögzítse a 2. ponton a küllőhöz.

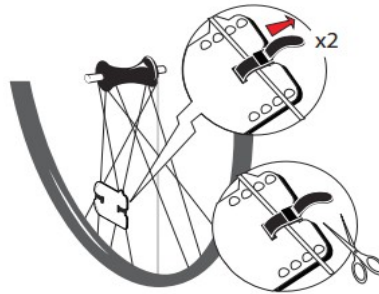

4. Húzza meg a gyorskötőzöt majd vágja le a felesleget.



5. Vegye ki az akkumulátor tartót.

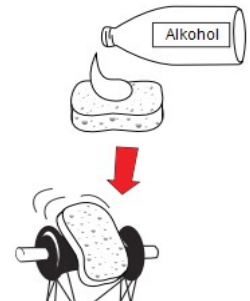

6. Tisztítsa meg az agyat.

